

The Filson Historical Society

Mss. Sutton, John I. d. 1810.

A

.S967 Land papers

2

Kentucky - Scott County

1796, 1799

46x10

*3 items*

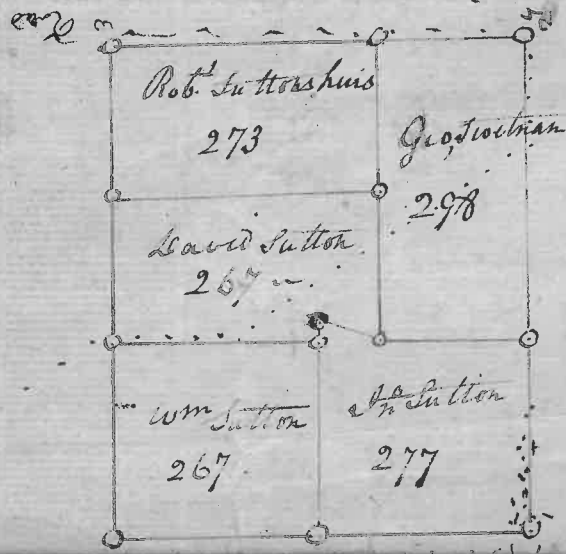

The Land is divided in the above  
 as in the face of the plate below  
 John Suttons S<sup>r</sup> five Child

5192

Survey, d for John Sutton S<sup>r</sup> 1782  
 Acre Land Beginning at an Elm on  
 Lane run thence S 20 W 436 poles  
 to a Stake in Seelys Field thence  
 N 70 W 504 poles to a Buckeye  
 Stump on Calhoons Road thence  
 N 20 E along S<sup>d</sup> Road 48 1/2 poles to  
 2 Sugar trees thence S 70 E 508  
 poles to the Beginning  
 February 14<sup>th</sup> 1799

in the above  
 manner  
 on the above  
 manner

The Filson Historical Society

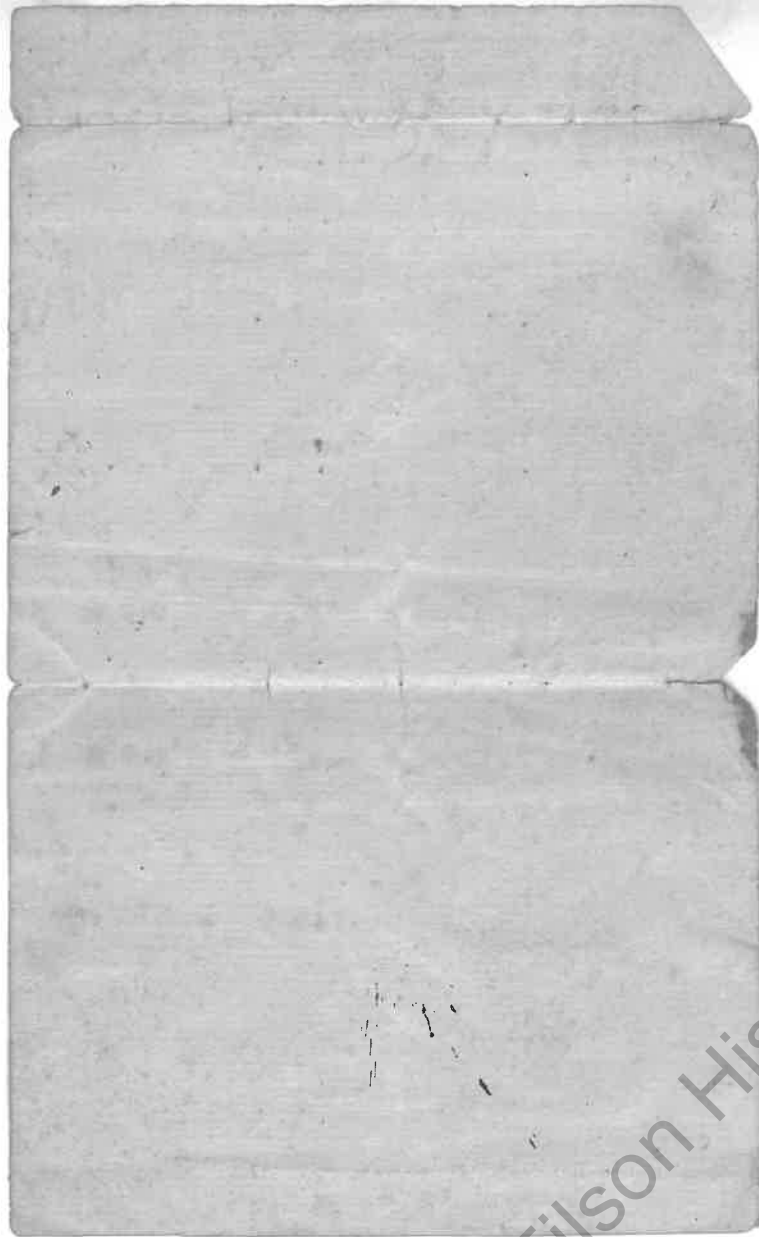

John Wilson's  
Dial of 1382 A.  
Lansdown



The Filson Historical Society

Area 1382 acres.

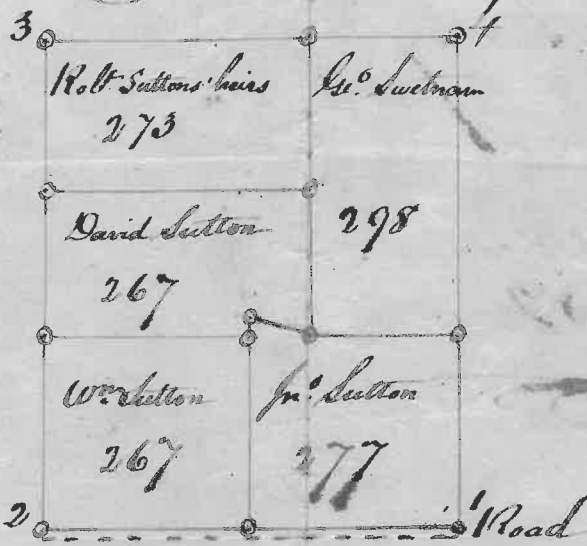

Surveyed for John Sutton Sen.  
1382 acres of Land.

Beginning at an Elm on corner Run  
thence N. 20° W. 436 poles to a stake  
in Duleys field thence N. 70° W.  
504 Poles to a Buckeye stump on  
Calhoun's road thence N. 20° E. along R.  
road 434 poles to 2 Squarres thence  
S 70° E. 508 poles to the beginning.

February 14<sup>th</sup> 1799  
B Collins

The land is divided in the above manner } 1410<sup>th</sup> 19<sup>th</sup> 1826  
as in the face of the plot between the } A Lightburn  
above John Sutton's part. five children. }

46 x 10

The Filson Historical Society

Collins  
to Survey  
Sutton

acres  
1382



1220  
1313 ac

The Filson Historical Society

May 29<sup>th</sup> 1796 Surv. for John Sutton Surv. of a half Acre of Land  
Beginning in the Middle of Cane Run in a line of the Heirs of  
Joseph Davis land & Corner with the Land Belonging to the  
Heirs of Samuel Grant Opposite a large Elm on the West  
Side of Cane Run about 2 poles from the Banks Corner to  
Grants Heirs N. S. 65. W. 44 poles with Grants line to  
their Corner & Buckeys in Sattons line N. with Sattons  
line S. 72. E. 120 po to the Middle of Cane Run  
Opposite Davises Corner a Buckeye Hackberry & White oak  
on the East Banks Thence down the Middle Thence off the  
Different Courses to the Beginning

5192

The Filson Historical Society

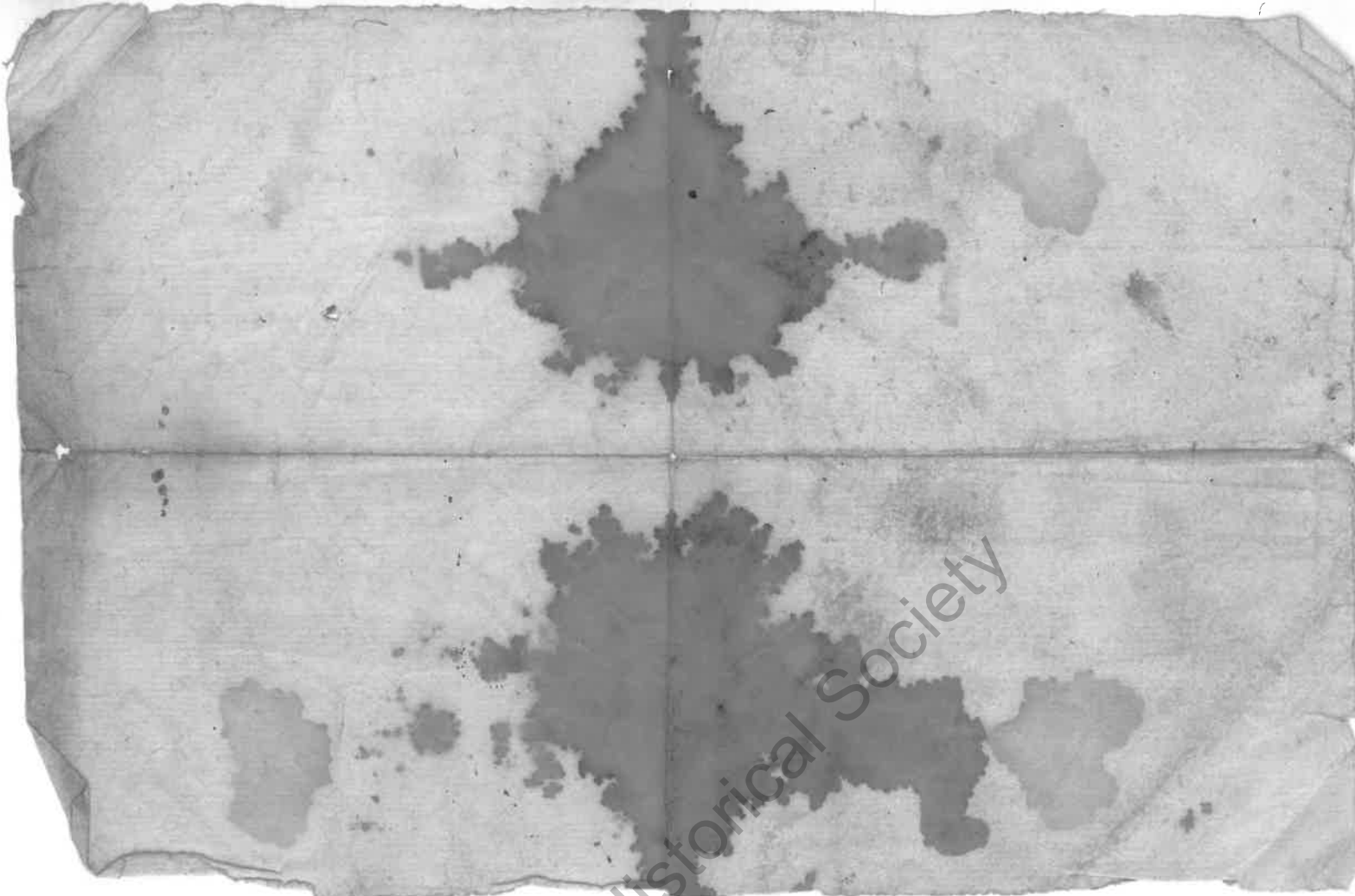

The Filson Historical Society

Potts County Court pt. May June 1811

Being called on as a commissioned agent  
to an act of assembly in such case made  
and provided for in this case by the  
heirs of John Sutton deed to secure the corner  
of said tract of Military land appt of Wm  
Henry having the title papers present &  
the County Surveyor we began at a stone  
marked S.S. corner to John Floyd thence  
with said Floyd south line crossing his  
S.W. corner to a stone marked S.S. in Patrick  
Henry's line thence with said line passing  
his S.E. corner to a stone marked S.S. corner  
to Richd May thence with said May  
and William Henry's line as marked  
passing the corner of Robt Sutton David  
Sutton and William Sutton to a stone  
marked W.S. in Thomas Kuleys Plantation  
thence passing Wens S.W. corner to the  
Requirements given under my hand  
this 4<sup>th</sup> day of May 1811.

James Thomson Com<sup>dr</sup>  
Jurat Copy att Ojato Hawkins D.C.  
For Belchambers cases



The Filson Historical Society

*Concord Report  
A copy att*